



Sustainable plumbing solutions for public and commercial sanitary rooms.

*Edition 3*



## Device connection fittings and angle valves

### For classic and modern requirements

The angle valve from SCHELL was a real innovation over 65 years ago - today it is a classic and has now been installed over 700,000,000 times worldwide. We are the market leader in angle valve technology, which we are constantly developing in order to be able to offer modern variants, for example the sampling angle valve for reliable testing of drinking water quality. Our portfolio now includes over 200 different designs. They all impress with their high quality of materials and workmanship as well as their long-lasting and reliable functionality.



## Variety of fittings from SCHELL

### Contract fittings for (semi-)public and commercial areas

In (semi-)public and commercial facilities, those responsible are confronted with constantly increasing requirements in the areas of hygiene, efficiency and sustainability. When it comes to planning and modernizing real estate, the challenge is also to reconcile economic efficiency, environmental friendliness and design. SCHELL always offers the right solution: The portfolio of high-quality, resource-saving, attractive and easy-to-install commercial fittings covers every installation situation. Contactless, electronic fittings provide the best support in protecting user health.



## Regulating Angle Valves

### Comfort Angle Valve

Regulating angle valve with COMFORT handle. Dezincification-resistant DR-brass.

- Comfort handle
- Long-push rod
- Regulating
- Push rosette Ø54mm
- Flow class A
- Noise Class I (Lowest noise in class)
- Test Mark: P-IX 212/IA
- DR Brass
- Brass ensures drinking water hygiene
- Double O-ring safety



Type/Option/Version	Colour and specification	Product Code	Matching Accessory
---------------------	--------------------------	--------------	--------------------



Chrome  
1/2 x 1/2

SL054360699

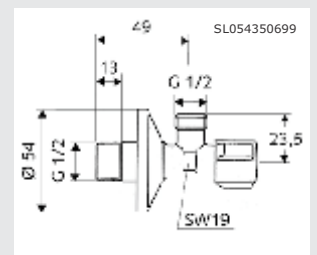

#### Customers also purchased



1/2 x 3/8 Angle valve  
SL054350699



1/2 x 1/2 Angle valve  
SL052170699

#### Scope of supply

Regulating angle valve  
Ø54mm Rosette



## Regulating Angle Valves

### Comfort Angle Valve

Regulating angle valve with COMFORT handle. Dezincification-resistant DR-brass.

- Comfort handle
- Long-push rod
- Regulating
- Push rosette Ø54mm
- Flow class A
- Noise Class I (Lowest noise in class)
- Test Mark: P-IX 212/IA
- DR Brass
- Brass ensures drinking water hygiene
- Double O-ring safety



Type/Option/Version	Colour and specification	Product Code	Matching Accessory
---------------------	--------------------------	--------------	--------------------



Chrome  
1/2 x 3/8

SL054350699

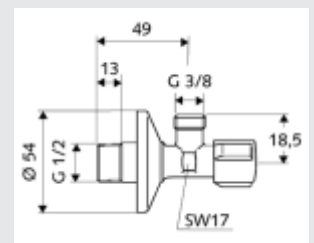

#### Scope of supply

Regulating angle valve  
Ø54mm Rosette

#### Customers also purchased



1/2 x 1/2 Angle valve  
SL054360699



1/2 x 1/2 Angle valve  
SL052170699



## Regulating Angle Valves

### Draw-Off Valve

Regulating angle valve with COMFORT handle for appliance connections.

- Comfort handle
- Long-push rod
- Regulating
- Push rosette Ø54mm
- Flow class A
- Noise Class I (Lowest noise in class)
- Test Mark: P-IX 212/IA



Type/Option/Version	Colour and specification	Product Code	Matching Accessory
---------------------	--------------------------	--------------	--------------------



Chrome  
1/2 x 3/4

SL03300699

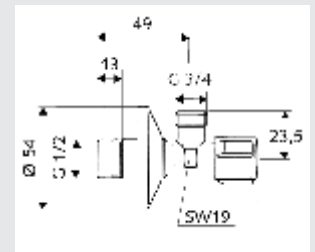

#### Scope of supply

Regulating angle valve  
Ø54mm Rosette

#### Alternative product suggestions



1/2 x 3/8 Angle valve  
SL054350699



1/2 x 1/2 Angle valve  
SL052170699



1/2 x 1/2 Angle valve  
SL054360699



## Self-Closing Taps

### Petit Wash Basin Tap

Vandal resistant single cold tap featuring manual actuation and automatic closing.

- Surface mounted
- Flow rate: max. 5ℓ/min independent of pressure
- Flow pressure: 1 to 5 bar
- Flow time: adjustable from 2-15 seconds
- DZR Brass housing



Type/Option/Version	Colour and specification	Product Code	Matching Accessory
---------------------	--------------------------	--------------	--------------------



Chrome  
Automatic closing

SL021300699



Regulating angle valve  
SL054360699

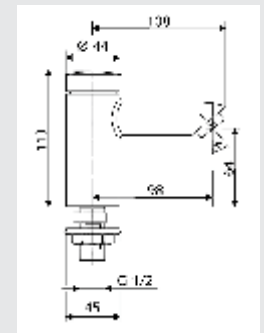

#### Spares



Replacement cartridge  
SLS297330099

#### Scope of supply

Single tap  
Mounting accessories  
Installation instruction



## Self-Closing Taps

### Petit Exposed Wash Basin Tap

Vandal resistant single cold tap featuring manual actuation and automatic closing.

- Wall mounted
- Flow rate: max. 5l/min independent of pressure
- Flow pressure: 0,8 to 5 bar
- Flow time: adjustable from 6-15 seconds
- With isolating valve in housing
- DZR Brass housing



Type/Option/Version	Colour and specification	Product Code	Matching Accessory
---------------------	--------------------------	--------------	--------------------



Chrome  
Automatic closing

SL021470699



Wall extension  
SL616620699

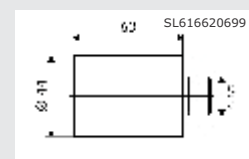
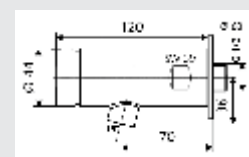

#### Scope of supply

Single tap  
Mounting accessories  
Installation instruction

#### Spares



Replacement cartridge  
SLS297330099





## Self-Closing Taps

### Modus E Wash Basin Tap

Vandal resistant tap featuring IR actuation and automatic shut off.

- Flow volume: max. 3 l/min independent of pressure
- Flow pressure: 0,5 - 5 bar
- Max. resting pressure 8 bar
- Water temperature max. 70°C
- Sensor range ≈ 2 - 17 cm
- Cleaning stop 120 s
- Material: DZR Brass housing
- Test Mark: P-IX 29853/IO
- Noise Class: 1
- Surface: chrome
- Packaging unit: 1
- Dimension: G 1/2 int. thread

Type/Option/Version	Colour and specification	Product Code	Matching Accessory
---------------------	--------------------------	--------------	--------------------



Chrome  
Electronic

SL021760699



Regulating angle valve  
SL054360699

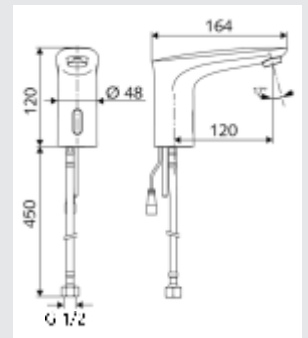

#### Spares

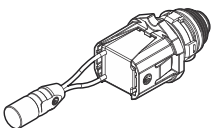

Solenoid valve  
SLS009230099

#### Scope of supply

Infrared sensor single hole tap  
Electronics programmable  
Solenoid valve  
1 flexible hose and prefilter  
Flow regulator  
Wash basin mounting accessories





## Self-Closing Taps

### Modus E Wash Basin Tap

Vandal resistant mixer tap featuring IR actuation and automatic shut off.

- Setting options via short range reflex
- Sensor range area (approx. 2-13 cm)
- Stagnation flush
- Cleaning stop (off/120 s)
- Flow at 3 bar: 3 l/min
- Flow pressure: 0.5 - 5.0 bar
- Max. Resting pressure: 8 bar
- Max. operating temperature: 70 °C
- Material: Housing DZR brass
- Surface: Chrome
- Projection to centre of aerator: 230 mm
- Connection: G 1/2 AG

Type/Option/Version	Colour and specification	Product Code
---------------------	--------------------------	--------------



Chrome  
Electronic

SL019550699

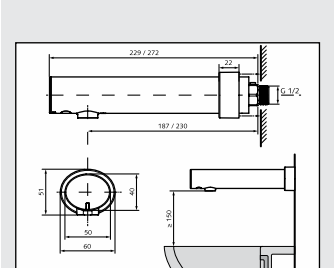

#### Spares

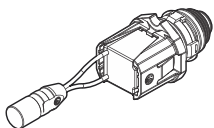

Solenoid valve  
SLS009230099

#### Scope of supply

Infrared sensor wall outlet tap  
Electronics programmable  
6V Solenoid valve  
Flow regulator  
Push rosette



## Flush Systems

### Concealed Urinal Flush

COMPACT II Design operating panel and flush valve set.

- Material: Brass and plastic
- Chrome surface (panel)
- Flow volume 0,3l/s
- Flow pressure 0,8-5,0 bar



Type/Option/Version	Colour and specification	Product Code	Matching Accessory
---------------------	--------------------------	--------------	--------------------



Brass fitting  
Plastic housing

SL011930099



Operating panel (chrome)  
SL028000699



Operating panel (stainless steel)  
SL028012899  
*(Vandal-resistant design)*



Operating panel (white)  
SL028001599

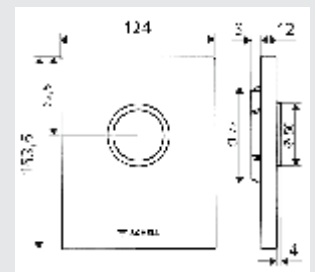
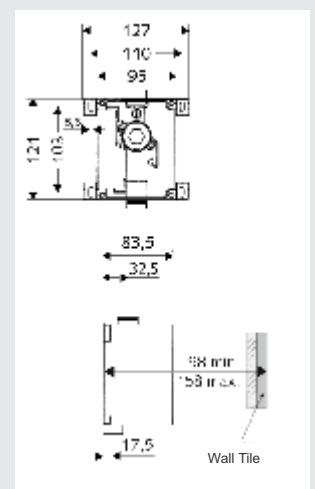

#### Spares



Replacement cartridge  
SLS296280099

#### Optional accessories



Urinal inlet connection  
SL031050099

#### Scope of supply

**FLUSH VALVE SET:**  
Masterbox  
Roughing-in housing  
Concealed flush valve COMPACT II,  
with isolating valve and sealing plug  
Flush-mounted cap

**OPERATING PANEL:**  
Operating button  
Self-closing cartridge with nozzle  
bore pre-filter  
Installation frame  
Fastening material



Flush Systems

### Schellomat Basic

Benelux model exposed urinal flush valve in robust all-metal.

- Material: Brass
- Chrome surface
- Flow volume 0,3l/s
- Flow pressure 0,8-5,0 bar
- Flow volume adjustable 1l-6l
- With service isolating valve



Type/Option/Version	Colour and specification	Product Code	Matching Accessory
---------------------	--------------------------	--------------	--------------------



Chrome

SL024840699

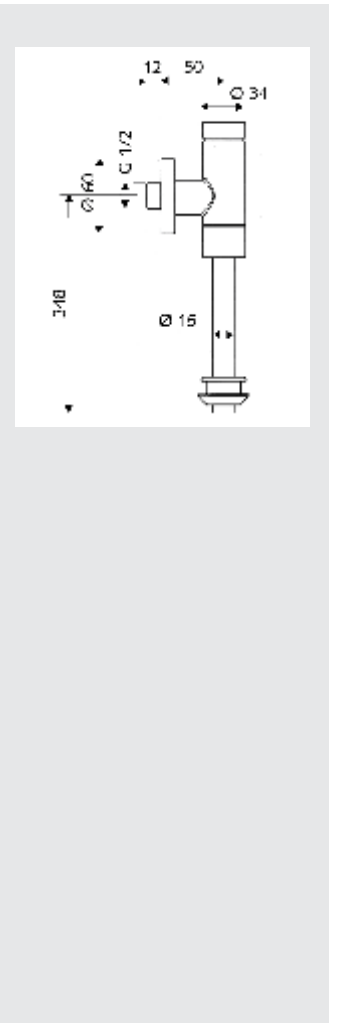

**Scope of supply**

Exposed urinal flush valve  
 Ø15x300mm flush pipe  
 With pipe break  
 Push rosette

**Spares**



Replacement cartridge  
 SLS294930099



## Flush Systems

### Concealed WC Flush Valve COMPACT II

Low-noise concealed flush valve.  
For combination with all SCHELL WC  
controls/operating panels.

- Material: Brass and plastic
- Flow volume 1,0 - 1,3ℓ/s
- Flow pressure 1,2 - 5,0 bar
- Outlet: Flush pipe Ø45mm



Type/Option/ Version	Colour and specification	Product Code	Matching Accessory
-------------------------	-----------------------------	-----------------	-----------------------



Brass fitting  
Plastic housing

SL011940099



WC operating panel (chrome)  
Edition  
SL028020699



Operating panel (stainless steel)  
SL028032899  
*(Vandal-resistant design)*



Operating panel (white)  
SL028021599

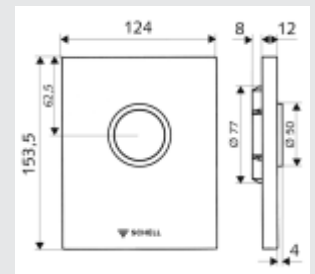
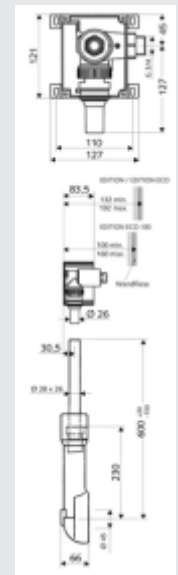

#### Scope of supply

Masterbox  
Roughing-in housing  
Concealed flush valve COMPACT II,  
with isolating valve and flush plug  
Pipe interrupter (DIN EN 12541)  
Flush-mounted cap  
Height-adjustable flush pipe with  
construction plug



Replacement cartridge  
SLS296260099



## Flush Systems

### Exposed WC Flush Valve

SCHELLOMAT Basic All-metal design with brass push button.

- Material: Brass and plastic
- Chrome surface
- Flow volume 1,0 - 1,3l/s
- Flow pressure 1,2 - 5,0 bar



Type/Option/Version	Colour and specification	Product Code	Matching Accessory
---------------------	--------------------------	--------------	--------------------



Brass fitting  
Chrome

SL022480699



WC flush pipe kit  
SL032090699

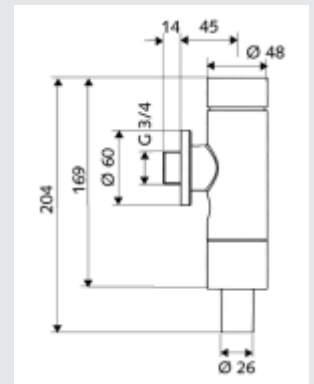

 Replacement cartridge SLS294900099				
--	--	--	--	--

#### Scope of supply

Exposed WC flush valve  
Self-closing cartridge with automatic nozzle cleaning needle  
Isolating valve  
Push rosette Ø 60 mm  
Flush pipe connection with pipe interrupter



Shower

### Comfort Flex Shower Head

Vandal-resistant shower head with soft jet and anti-limescale knobs.

- Flow rate max. 9,5ℓ/min. Independent of pressure
- Tilt angle range 12-32°
- Material: Brass
- Surface: chrome
- Packaging unit: 1
- Dimension: DN 15 G 1/2 ext. thread

Type/Option/Version	Colour and specification	Product Code	Matching Accessory
---------------------	--------------------------	--------------	--------------------



Chrome

SL018210699

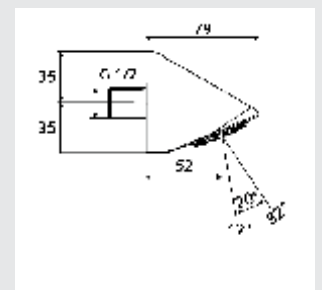

**Scope of supply**

Shower head



Whilst Larson has used its best endeavours to ensure that the information provided in this catalogue - including (but not limited to) technical specifications, measurements and colours - are accurate and up to date at the time of issue, does not warrant that it is correct or complete. We reserve the right to make corrections and changes without notification and unless otherwise stated and agreed upon in writing, Larson makes no warranties of any kind, express or implied, that goods sold are suitable for any particular purpose or application under any specific condition. It is recommended that every item should be thoroughly tested by the purchaser to determine performance suitability before use of goods.



